

SMART STOP™

WELKER SMART STOP™ DOES ALL STOPPING & SENSING FUNCTIONS IN ONE PART.
MINIMIZES ENGINEERING, FIELD SET UP AND OPERATOR ADJUSTMENT TIME.

ELIMINATES:

- ∅ NEED FOR SEPARATE MOUNTS, BRACKETS & FLAGS.
- ∅ NEED FOR SWITCH ADJUSTMENTS WHEN SHIMMING.
- ∅ IMPROPER ADJUSTMENT OF OUTBOARD SWITCHES.
- ∅ OUTBOARD SWITCH VIBRATING LOOSE IN BRACKET.
- ∅ PROTECTING OUTBOARD PROXES FROM BEING STEPPED ON OR BENT IN TOOLS.

**NAAMS
INTERCHANGEABLE**

ASC021-PD

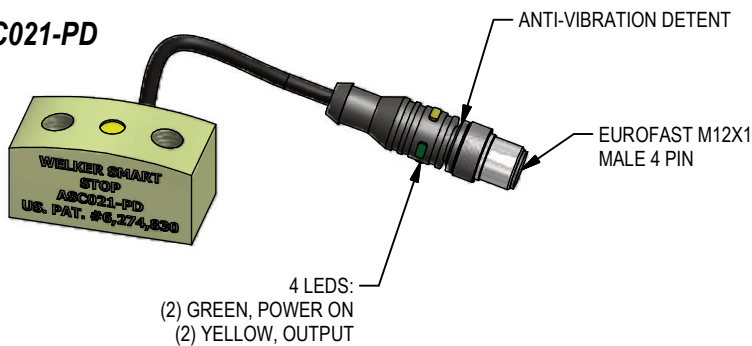

ASC020-PD

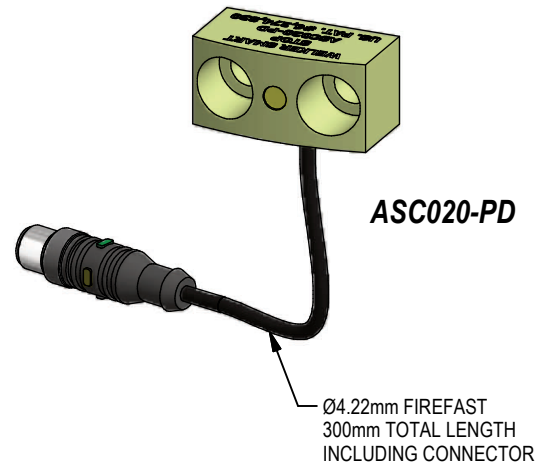

SMART STOP SHOWN ON NL3 RAIL SLIDE (2 REQUIRED)

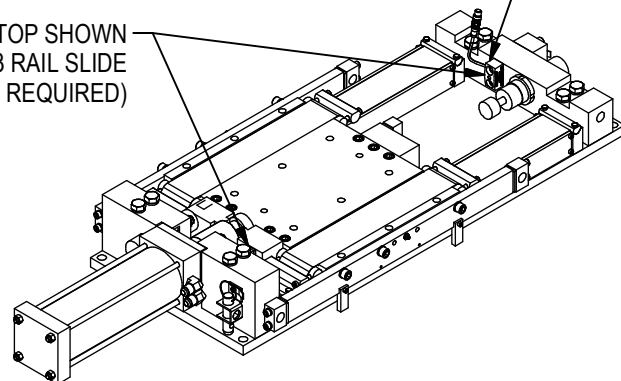

RELEASED 4/9/18

ORDERING INFORMATION: 25mm TALL SERIES USING M10 FASTENERS

ORDER AS OPTION "P" ON THESE WELKER SLIDES:

- P5, P7 Plane Bearing Slides
- H7 Plane Bearing Slide
- R2 Rolling Element Slide
- NL3 Narrow Low Profile Rail Slide
- WL3 Wide Low Profile Rail Slide
- LP1, LP2 Compact Rail Slides
- DB4 Guided Slide

TO ORDER SEPARATELY OR AS REPLACEMENT PART USE PART NUMBERS BELOW:

DIMENSIONS

(CABLE & CONNECTOR NOT SHOWN FOR CLARITY)

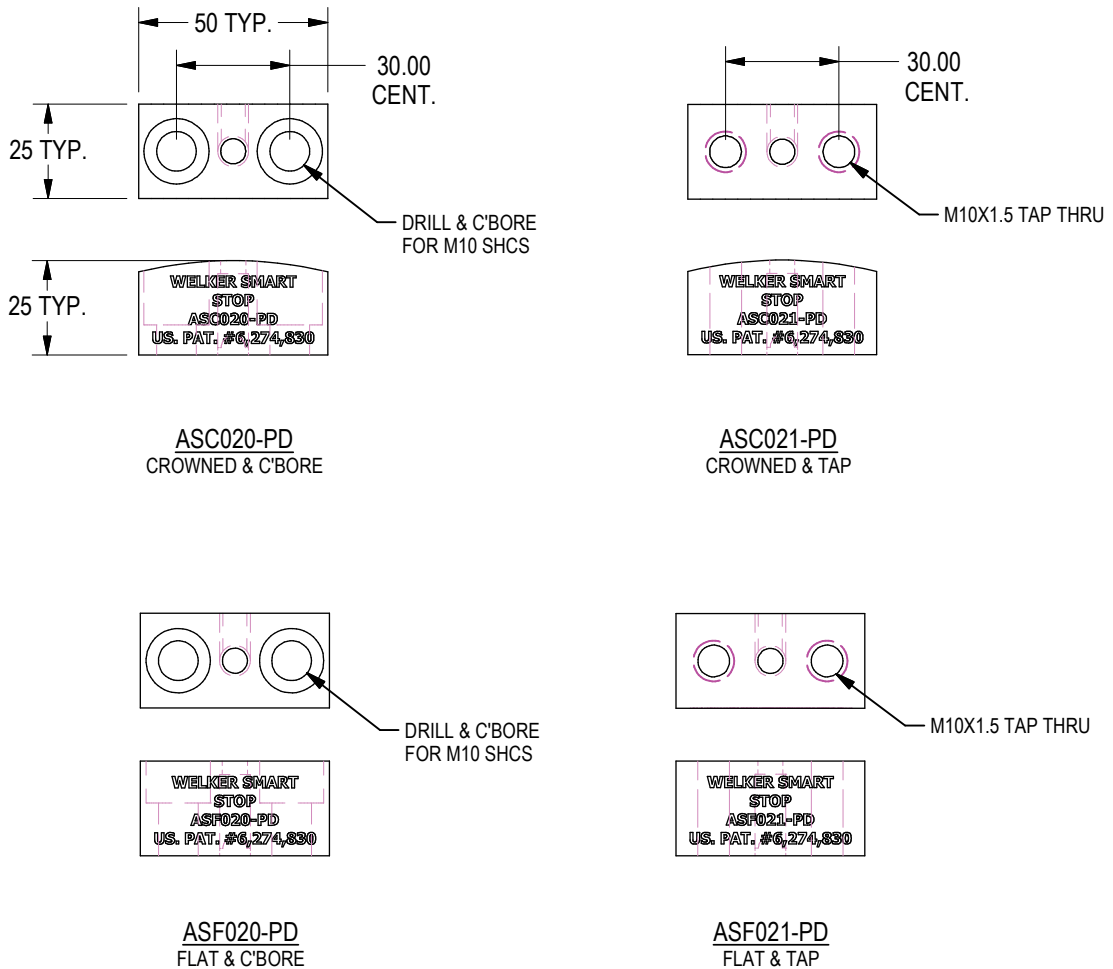

(DO NOT SCALE DRAWING)



ORDERING INFORMATION: 20mm TALL SERIES USING M8 FASTENERS

DIMENSIONS

(CABLE & CONNECTOR NOT SHOWN FOR CLARITY)

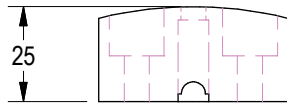
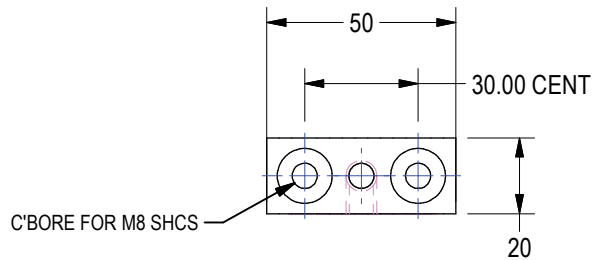

ASC018-PD
CROWNED & C'BORE

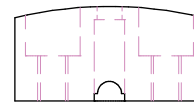
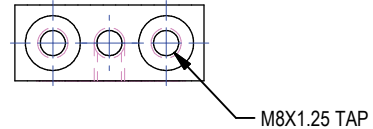

ASC019-PD
CROWNED & TAP

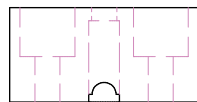
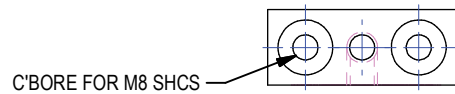

ASF018-PD
FLAT & C'BORE

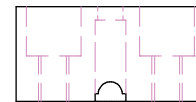
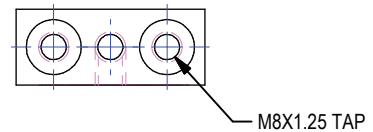

ASF019-PD
FLAT & TAP



(DO NOT SCALE DRAWING)



SMART STOP SWITCH: GENERAL SPECIFICATIONS

CONTACT CARRIER MATERIAL	PUR
MOLDED HEAD MATERIAL/COLOR (RSE)	THERMOPLASTIC PUR/BLACK
CONTACT MATERIAL/PLATING (RSE)	GOLD-PLATED BRASS
COUPLING NUT MATERIAL/PLATING (RSE)	NICKEL-PLATED BRASS
RATED OPERATING DISTANCE	2mm = .079" (NOMINAL) APPROX +0.5mm -1.0mm
MOUNTING MODE	FLUSH
HYSTERESIS (DIFFERENTIAL TRAVEL)	3-15%
MAX. RELATIVE TEMPERATURE DRIFT	LESS THAN OR EQUAL TO $\pm 10\%$
MIN. REPEAT ACCURACY	LESS THAN OR EQUAL TO 2%
OPERATING TEMPERATURE	-25 TO 70° (-13 TO 158° F)
RATED OPERATIONAL VOLTAGE (DC)	10-30 VDC
MAX. RIPPLE	LESS THAN OR EQUAL TO 10%
RATED OPERATIONAL CURRENT	LESS THAN OR EQUAL TO 150 mA
NO-LOAD CURRENT	LESS THAN OR EQUAL TO 15mA
MAX. OFF-STATE CURRENT	LESS THAN OR EQUAL TO 0.1mA
MAX SWITCHING FREQUENCY	LESS THAN OR EQUAL TO 2kHz
RATED INSULATION VOLTAGE	0.5 kV
OUTPUT FUNCTION	3-WIRE, NORMALLY OPEN, PNP
SHORT-CIRCUIT PROTECTION	YES
MAX. VOLTAGE DROP	LESS THAN OR EQUAL TO 1.8 V
WIRE BREAKAGE/REVERSE POLARITY PROTECT	YES
DEGREE OF PROTECTION	IP 67
HOUSING MATERIAL	SST, V2A 1.4301
ACTIVE FACE	PLASTIC, PA12-GF30
OUTER CABLE JACKET (SENSOR)	3mm PUR
VIBRATION RESISTANCE	55 Hx (1mm)
SHOCK RESISTANCE	30 x g (11 ms)
PIGTAIL LED COLOR	GREEN=POWER, YELLOW=OUTPUT

SMART STOP IS USED TO SENSE FULL STOP AGAINST BLOCK (ONLY)

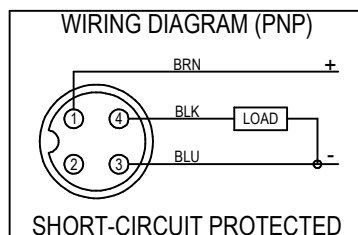

(DO NOT SCALE DRAWING)

WELKER
ENGINEERED PRODUCTS
800-229-0890 www.welkerproducts.com

SMART STOP™ PANCAKE SWITCHES

ALL PANCAKE SWITCH BLOCKS USE THESE FASTENERS:
M8 IN C'BORES M10 IN TAPS

ORDERING INFORMATION

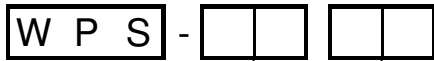

Block

- 01 Wide Flat
- 02 Wide Crown
- 03 Wide Target
- 04 Narrow Flat
- 05 Narrow Crown
- 06 Narrow Target

Switch

- 00 No Switch
(Default for blocks 03 & 06)
- 01 Turck ~ BI 5U-Q08-AP6X2-0.2M-RS 4T/S1589 (3-Wire, 4-Pin)
- 02 Balluff ~ BES R01ZC-PSC50B-BZ00,2-GS04-W05 (3-Wire, 4-Pin)
- 03 Peppri + Fuchs ~ NMB6-F104M-E2-C-FE-200MM-V1 (3-Wire, 3-Pin)
Metal faced, weld immune

All Switches are DC M12 X 1 (PNP) Connector

WIDE SERIES PANCAKE SWITCHES*

WIDE SERIES SWITCHES CAN BE FIELD REVERSED TO HAVE THE CORD EXTEND THE OPPOSITE DIRECTION

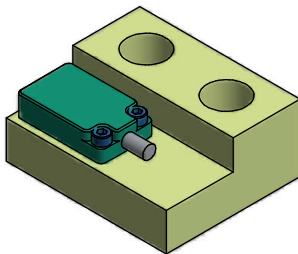

BLOCK 01
WIDE FLAT

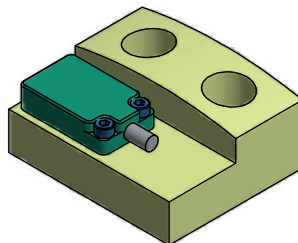

BLOCK 02
WIDE CROWN

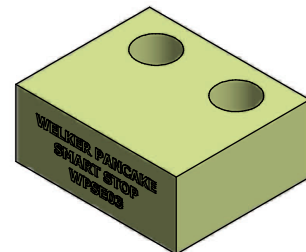

BLOCK 03
WIDE TARGET

NARROW SERIES PANCAKE SWITCHES*

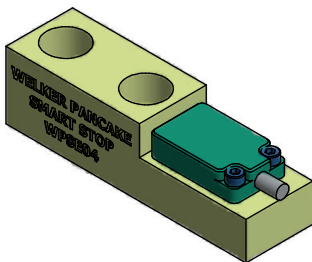

BLOCK 04
NARROW FLAT

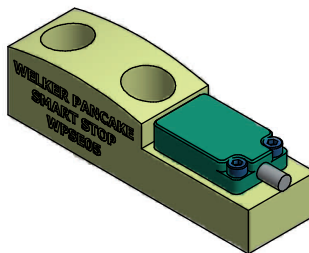

BLOCK 05
NARROW CROWN

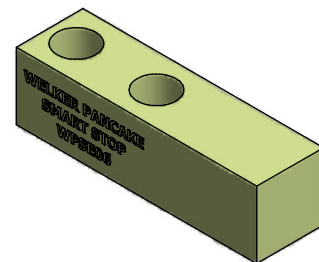

BLOCK 06
NARROW TARGET



*BLOCK DIMENSIONS ARE ON FOLLOWING PAGES

(DO NOT SCALE DRAWING)



WIDE SERIES BLOCK DIMENSIONS

**BLOCK 01
WIDE FLAT**

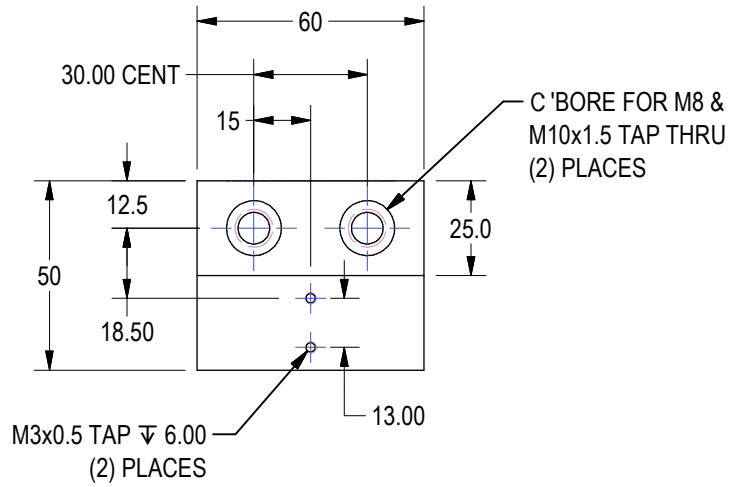
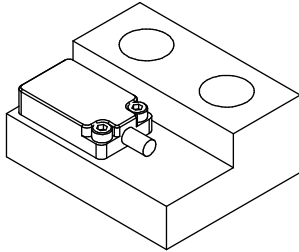

**BLOCK 02
WIDE CROWN**

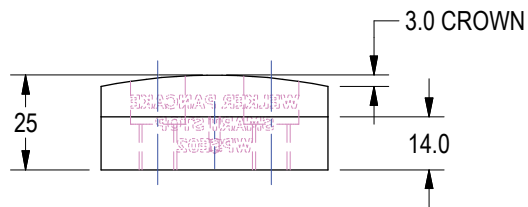
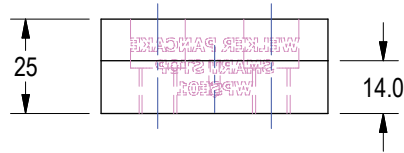
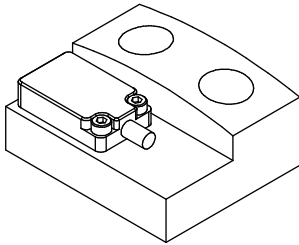

**BLOCK 03
WIDE TARGET**

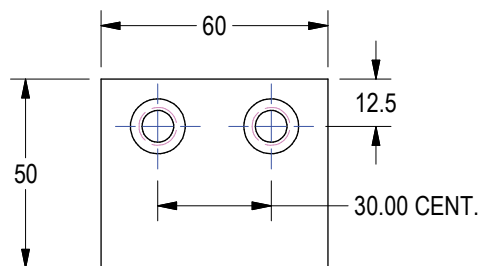
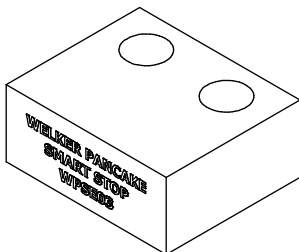

(DO NOT SCALE DRAWING)



NARROW SERIES BLOCK DIMENSIONS

**BLOCK 04
NARROW FLAT**

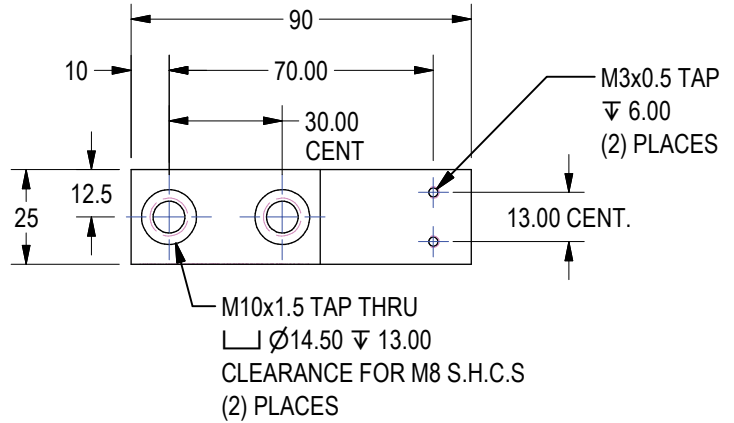
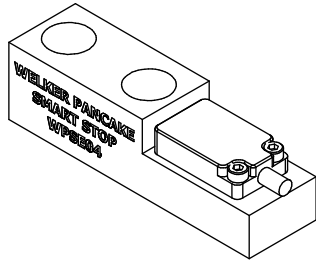

**BLOCK 05
NARROW CROWN**

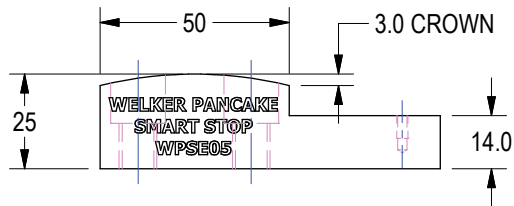
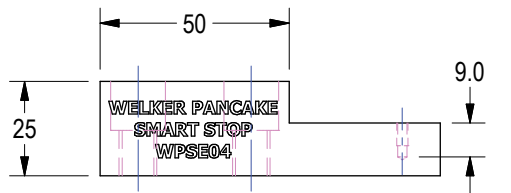
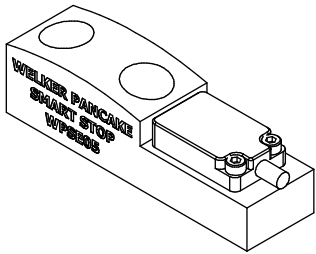

**BLOCK 06
NARROW TARGET**

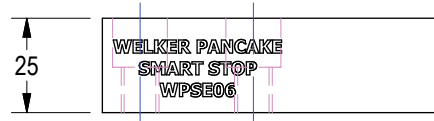
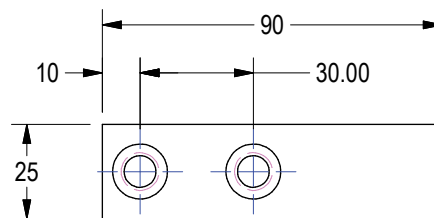
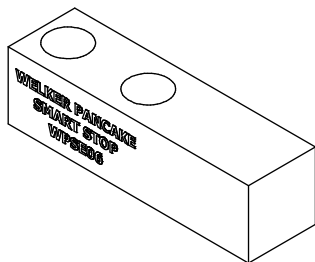

(DO NOT SCALE DRAWING)

